

2PM series circular connector

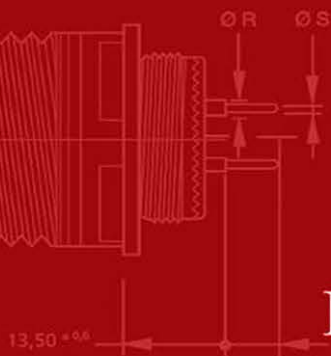

Renhotec Group Limited



BTHREAD

17,30 max.



2PM Type Connector

www.renhotec.com

Russia Standard 2PM Type

2PM series circular electrical connectors mainly adopt Russian connector technology. It is widely used for electrical connection and signal transmission between electrical equipment in railway system, trams and trolley bus etc. Its unique structure can make up for the shortcomings of many other similar connectors, making it more convenient and scientific to use. The cable plug and panel socket are threaded connection. The panel socket has a glass sintered sealed socket (M) and a glass sintered sealed wall socket (C), which can simultaneously meet the use requirements in special environments such as vacuum, sealing, and high temperature. Now there are mainly 2PM14/18/22/24/27/30/33/36 and other specifications, its special structure and performance have won the general recognition of the market. At the same time, it can be matched and interchanged with original parts of Russian 2PMT and 2 series.



Product Parameters

Connector type: Cable plug /panel socket

Orientation: Straight/Angled

Connection method: Thread connection

Shell Material: Aluminum alloy

Contact Material: Copper with silver/gold plated

Shell Size: 2PM14/18/22/24/27/30/33/36/39...

Pin number: 4/7/8/10/19/20/22/24/32...

Termination: Solder

Mating Cycles: 500 times

Working Voltage: $\geq 400V$

Working Current: 5-40A

Insulator: bakelite/PBT

Operating temperature: -60 - +200

Insulation resistance: Normal $\geq 20M\Omega$ Moistheat $\geq 2M\Omega$ Contact resistance: 0.5-2.5m Ω

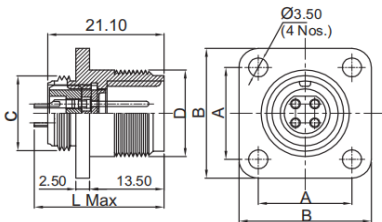

SHELL SIZE	14	18	22	24	27	30	33	36	39	42	45
A	17	20	23	26	29	31	32	35	37	40	43
B	24	27	30	33	36	38	40	43	46	49	52
C (LH) THREAD	M14X1.0	M18X1.0	M22X1.0	M24X1.0	M27X1.0	M30X1.0	M33X1.0	M38X1.0	M39X1.0	M42X1.0	M45X1.0
D (RH) THREAD	M16X1.0	M20X1.0	M24X1.0	M27X1.5	M30X1.5	M33X1.5	M38X1.5	M39X1.5	M39X1.5	M45X1.5	M48X1.5

For connectors with $\phi 1.0$ and $\phi 1.5$ mm contacts dimension L=26.00 max.

For connectors with $\phi 2.0$ and $\phi 3$ mm contacts dimension L=28.00 max.

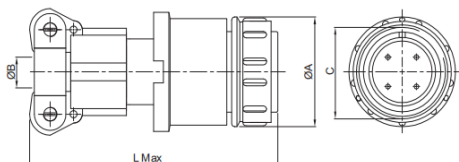

SHELL SIZE	14	18	22	24	27	30	33	36	39	42	45
A MAX	22	25	29	32	35	39	42	45	48	51	54
B (MIN) CABLE ENTRY DIA	6.5	10.5	14.50	16.50	18.50	20.50	23.00	23.00	24.50	30.50	30.50
C (RH) THREAD	M16X1.0	M20X1.0	M24X1.0	M27X1.5	M30X1.5	M33X1.5	M36X1.5	M39X1.5	M39X1.5	M45X1.5	M48X1.5
L MAX	53.50	53.50	56	62.50	62.50	62.50	57.50	67.50	67.50	67.50	67.50

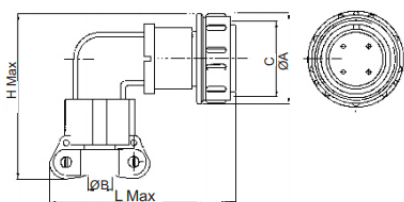

SHELL SIZE	14	18	22	24	27	30	33	36	39	42	45
A MAX	22	25	29	32	35	39	47	45	48	51	54
B (MIN) CABLE ENTRY DIA	6.5	10.5	14.50	16.50	18.50	20.50	23.00	23.00	24.50	30.50	30.50
C (RH) THREAD	M16X1.0	M20X1.0	M24X1.0	M27X1.5	M30X1.5	M33X1.5	M36X1.5	M39X1.5	M39X1.5	M45X1.5	M48X1.5
L MAX	51.5	58	62	64	67	71	71	71	74	81	88
H MAX	37.5	41	47.5	50	53.5	57.5	50.5	63.5	56.5	69.5	72.5

ORDER INFORMATION

Shell Size: 2PM14/18/22/24/27/30/33/36/39/42/45

K: Female J: Male

Number of contacts: 4/7/8/10/19/20/22/24/32 ...

2PM 14 K 4 Q A 2

1 : Gold plated pin
2 : Silver plated pin

Q: Straight W: Right Angle Z: Flange Receptacle

A: Shielded B: Unshielded

Contact layout diagrams for 2PM

Contact layout diagrams for 2PMA

Ex: Shell Size / No. of Contacts / Combination No.

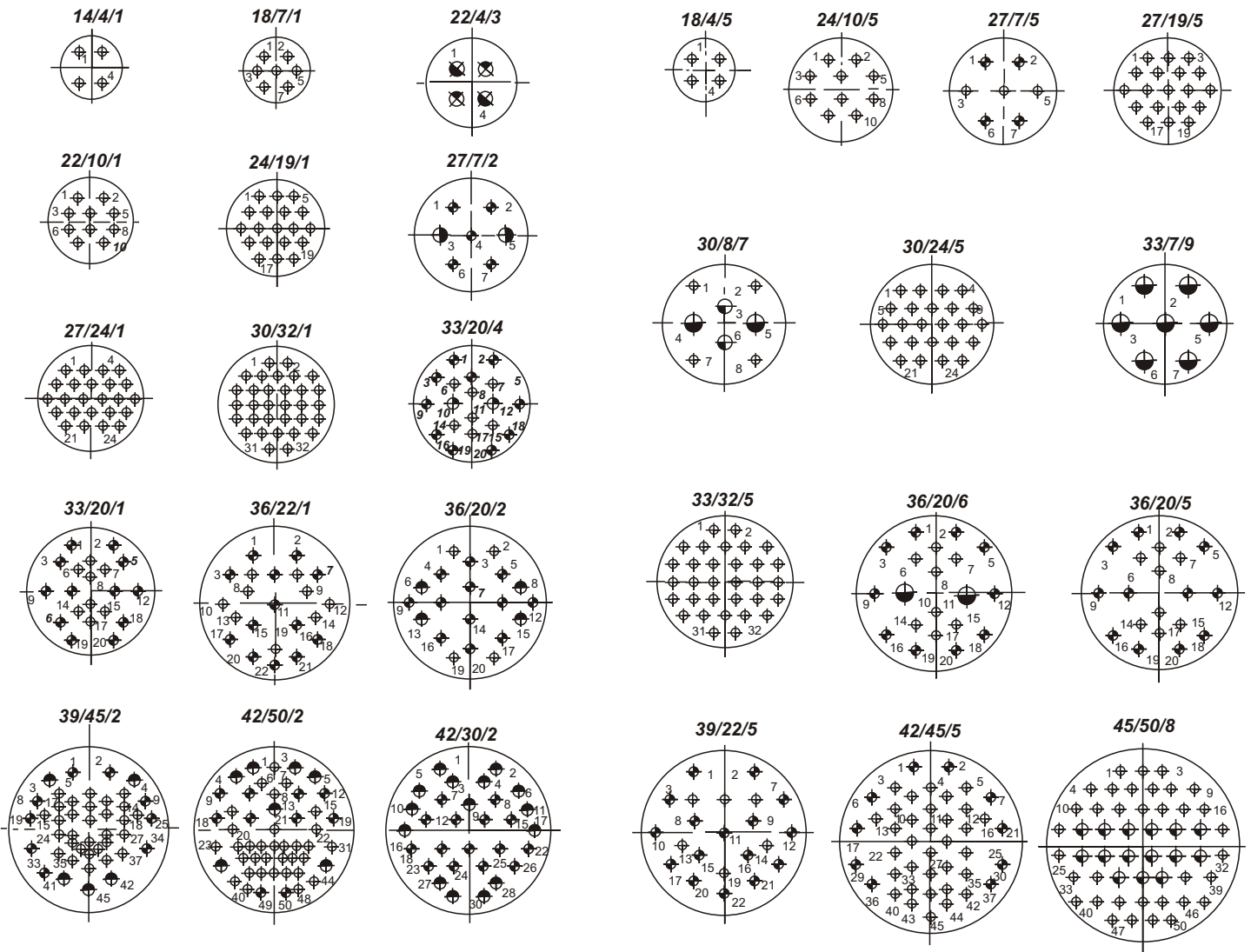

Contact configuration in insert									
For 2PM size.									
Sr. No.	Inserts			Contacts					
	Shell Size	No. of Contacts	Combination No.	1.0	1.5	2.0	2.0 A	3.0	3.0 A
1	14	4	1	4	-	-	-	-	-
2	18	7	1	7	-	-	-	-	-
3	22	4	3	-	-	2	-	2	-
4	22	10	1	10	-	-	-	-	-
5	24	19	1	19	-	-	-	-	-
6	27	24	1	24	-	-	-	-	-
7	30	32	1	32	-	-	-	-	-
8	33	20	4	18	-	-	-	2	-
9	39	45	2	40	5	-	-	-	-
10	42	50	2	43	7	-	-	-	-
For 2PMA size.									
1	18	4	5	-	4	-	-	-	-
2	24	10	5	-	10	-	-	-	-
3	27	19	5	-	19	-	-	-	-
4	30	8	7	-	4	-	2	-	2
5	30	24	5	-	24	-	-	-	-
6	33	32	5	-	32	-	-	-	-
7	36	20	6	-	18	-	-	-	2
8	42	45	5	-	45	-	-	-	-
9	33	7	9	-	-	-	-	-	7
10									

2PM

2PM

(C), (M)
2PM14/18/22/24/27/30/33/36



2PMT 2

: 400V AC
: $\phi 1.0-5A$ $\phi 1.5-10A$
: $\phi 1.0-0.005\Omega$ $\phi 1.5-0.0025\Omega$
: , 20
: 2
: -60 ~ +200 : 133,37 \times 10-12
: 10~200 , 10 : 500

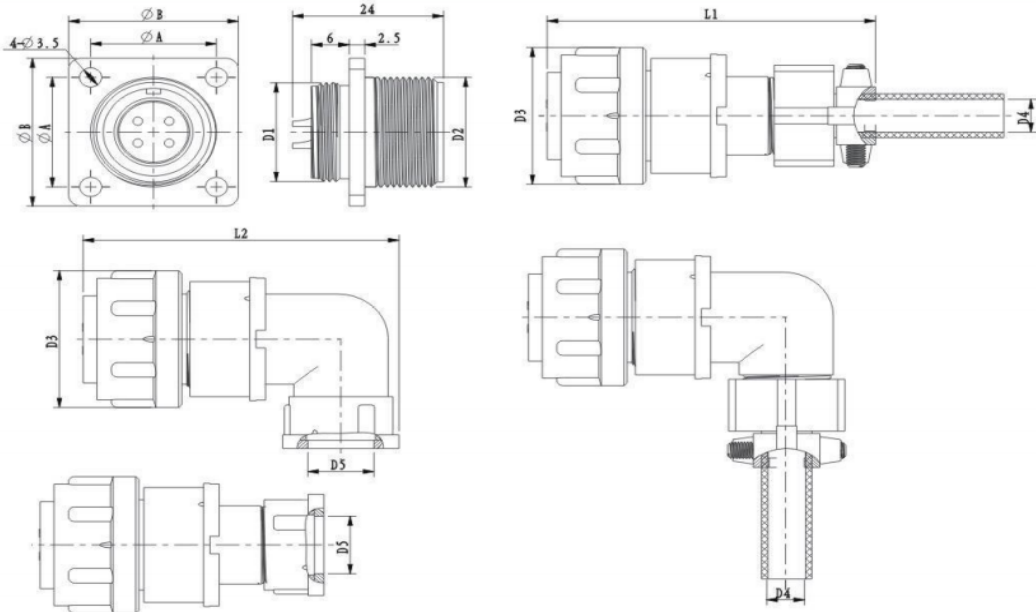

:14.18.22.24.27.30.33.36.39.42.45...

2PM-14	2PM-18	2PM-22	2PM-24
4	4	4	10
10	7	10	19

2PM 14 K 4 Q A 2



4.7.10.19.20.22.24.
45.50...

2PM

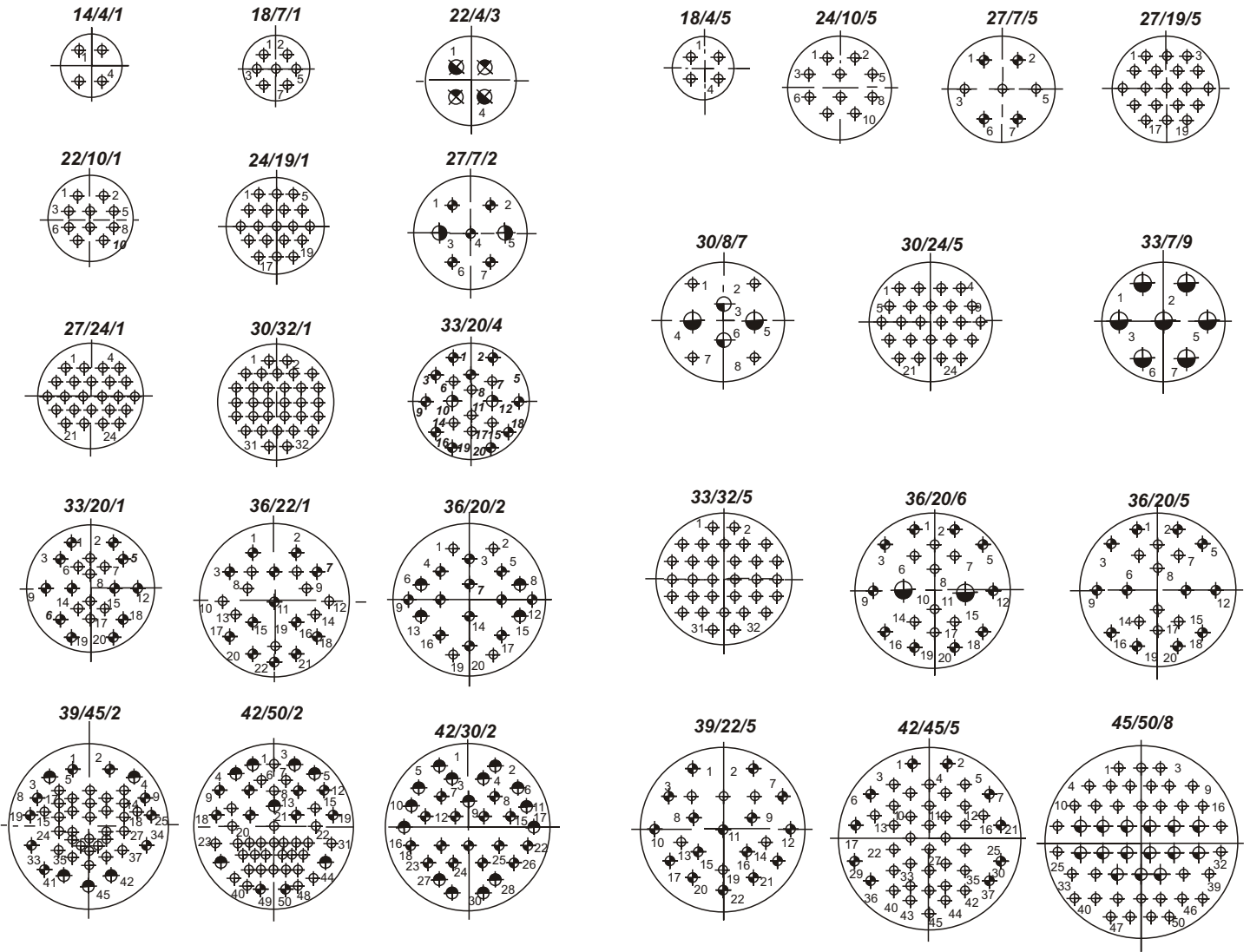

2PM.									
Sr. No.		-		1.0	1.5	2.0	2.0 A	3.0	3.0 A
1	14	4	1	4	-	-	-	-	-
2	18	7	1	7	-	-	-	-	-
3	22	4	3	-	-	2	-	-	-
4	22	10	1	10	-	-	-	-	-
5	24	19	1	19	-	-	-	-	-
6	27	24	1	24	-	-	-	-	-
7	30	32	1	32	-	-	-	-	-
8	33	20	4	18	-	-	-	2	-
9	39	45	2	40	5	-	-	-	-
10	42	50	2	43	7	-	-	-	-
1	18	4	5	-	4	-	-	-	-
2	24	10	5	-	10	-	-	-	-
3	27	19	5	-	19	-	-	-	-
4	30	8	7	-	4	-	2	-	2
5	30	24	5	-	24	-	-	-	-
6	33	32	5	-	32	-	-	-	-
7	36	20	6	-	18	-	-	-	2
8	42	45	5	-	45	-	-	-	-
9	33	7	9	-	-	-	-	-	7
10									

Renhotec Group Limited

Head Office:

No.555, Wenhua Avenue, Hongshan District 430070, Wuhan City, Hubei, China.

Factory 1:

No.25, Ningjiang Road, Humen Town, Dongguan City, Guangdong Province, China.

Factory 2:

Building 5, Wanyang Zhongchuang City, Daze Park, Shenjiang Industrial Park, Daze Town, Xinhui District, Jiangmen City, Guangdong Province, China

Web: <https://renhotec-industrial.com>

Tel: +86 15925121787

Email: sale@renhotec.com